

2D HINGE

FEATURES

PRE-ASSEMBLED
mechanism

COATING (monocolor)
Nickel
Japanese Gold
Ruthenium

EASY TO ASSEMBLY
user friendly

UP&DOWN
movement

PERFORMANCES

WEAR RESISTANCE
30,000 open/close cycles
(mechanism lifecycle)
30,000 up/down cycles
(mechanism lifecycle)

NO ROCKING
Self Alignment System

PULLING RESISTANCE
(mechanism)
over 250N

PATENTED

COVERED BY INTERNATIONAL PATENT



2D Hinge

Two-Dimensional movement in a unique solution



Special spring hinge

FOR

Innovative Frames



PATENTED

2D HINGE

Special Spring Hinge

for Innovative Frames

V
VISOTTICACOMOTEC

HINGES AND WIRECORES FOR FRAMES

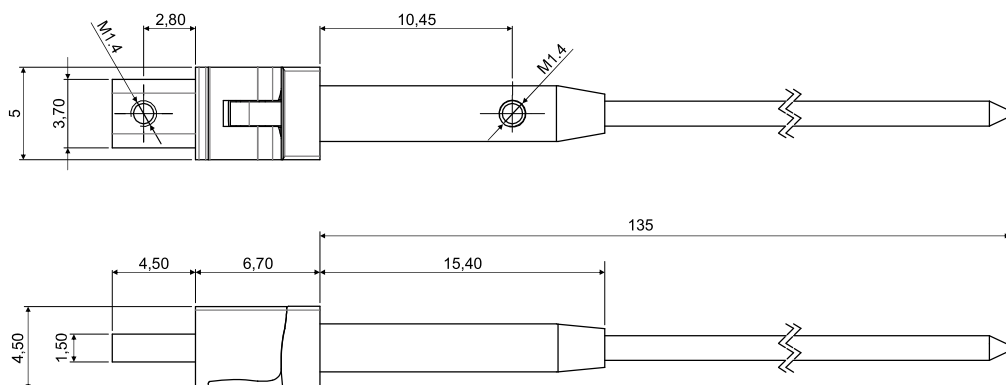

ASSEMBLED WIRECORE

NICKEL PLATED	03TFC9485A135BNX
JAPANESE GOLD PLATED	03TFC9485A335BDX
RUTHENIUM PLATED	03TFC9485A435BUX

Material: **Nickel silver**

SCREW

ASSEMBLING SCREW AVAILABLE

Material: **Stainless steel**

